

SHOT CLOCK SPECIFICATIONS:
 OVERALL SIZE: 32.00(W) x 32.00(H) x 6.00 (DP)

LED SPECIFICATION:
 14" RED LED DIGITS (SHOT CLOCK TIME)
 7" AMBER LED DIGITS (GAME TIME)

ELECTRICAL SPECIFICATIONS:
 110VAC, 60HZ. / 2AMP

APPROX. WEIGHT - 20 LBS

REVISION	DESCRIPTION	AUTHOR	DATE
A	INITIAL DESIGN	AS	21/05/2010

PART NUMBER: EN505C

NOTICE TO PERSON RECEIVING THIS DRAWING AND TECHNICAL INFORMATION:

OES, INC. CLAIMS PROPERTY RIGHTS TO THE MATERIAL DISCLOSED HEREIN. THIS DRAWING INCLUDES UNPUBLISHED PROPRIETARY MATERIAL DEVELOPED BY OES, INC. AND AS SUCH IS NOT TO BE COPIED, REPRODUCED OR USED IN ANY WAY WITHOUT PRIOR WRITTEN AUTHORIZATION FROM OES, INC.

TOLERANCE INFORMATION
 Dimensions are in Inches
 Fractional ± 1/16"
 Two Place Decimals ± 0.02"
 Three Place Decimals ± 0.005"
 Four Place Decimals ± 0.0005"
 Angular ± 30'

THIRD ANGLE PROJECTIONS

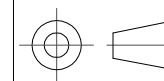

4056 Blakie Road,
 London, ON, N6L 1P7
 Tel: (519) 652-5833
 Fax: (519) 652-3795
 Email: oes@oes-inc.com

DESCRIPTION
**OES ELECTRONIC SCOREBOARD
 SHOTCLOCK - S**

SIZE	FILENAME	INIT DRAWING DATE	REV
B	SHOTCLK-S-INFO	21/05/2010	A
USE FOR REVIEW			
SCALE	NTS	DRAWN BY	AS
		PAGE	1 OF 1